

(1) CERTIFICATE

- (2) No. of the Certificate: **ZP/B144/22-PZ**
- (3) Product: **Anchor device type A**
Type: ABS-Lock® -360
- (4) Manufacturer: **ABS Safety GmbH**
- (5) Address: **Gewerbering 3, 47623**
- (6) The design of this product and any acceptable variation thereto are specified in the appendix to this certificate.
- (7) The Certification Body of DEKRA Testing and Certification GmbH certifies that this product complies with the requirements of the test regulations listed under item 8 below. The test results are recorded in report PB 22-102_Rev.01.
- (8) The requirements are assured by compliance with
DIN EN 795:2012 **DIN CEN/TS 16415:2017**
- (9) This certificate relates only to the design and tests of the specified product in accordance to the contemplated requirements. Further requirements applied to the manufacturing process and supply of this product, are not covered by this certificate.
- (10) The manufacturer is authorised to apply the mark of conformity to the products that conform to the types examined.
- (11) This certificate is valid until 2029-04-25.



DEKRA Testing and Certification GmbH
Bochum, 2024-04-26

Signed: Brumm
Managing director

We confirm the correctness of the translation from the German original.
In the case of arbitration only the German wording shall be valid and binding.

A handwritten signature in blue ink, appearing to be "A. Brumm", written over a horizontal line.

Managing director

TRANSLATION

- (12) Appendix to
- (13) **Certificate**
ZP/B144/22-PZ
- (14) 14.1 Subject and type
Anchor device type A
Type: ABS-Lock® -360

14.2 Description

The anchor device of type ABS-Lock® -360 (Fig. 1 – 3) and its possible variants is used as a single anchor point to protect maximum three persons against falls from a height; it is intended for assembly on surfaces of concrete or steel of sufficient strength. For the assembly, an appropriate fastening element is inserted into the two-part round base (Ø 50.0 mm) using a sleeve.

On the side of the base, there are two drill holes (Ø 10.0 mm) which are used to receive the attachment eyelet (t = 8 mm). The user connects his personal protective equipment to this eyelet to protect himself against falls from a height. The anchor device is made to bear loads exerted from any direction and is made of corrosion-resistant material.

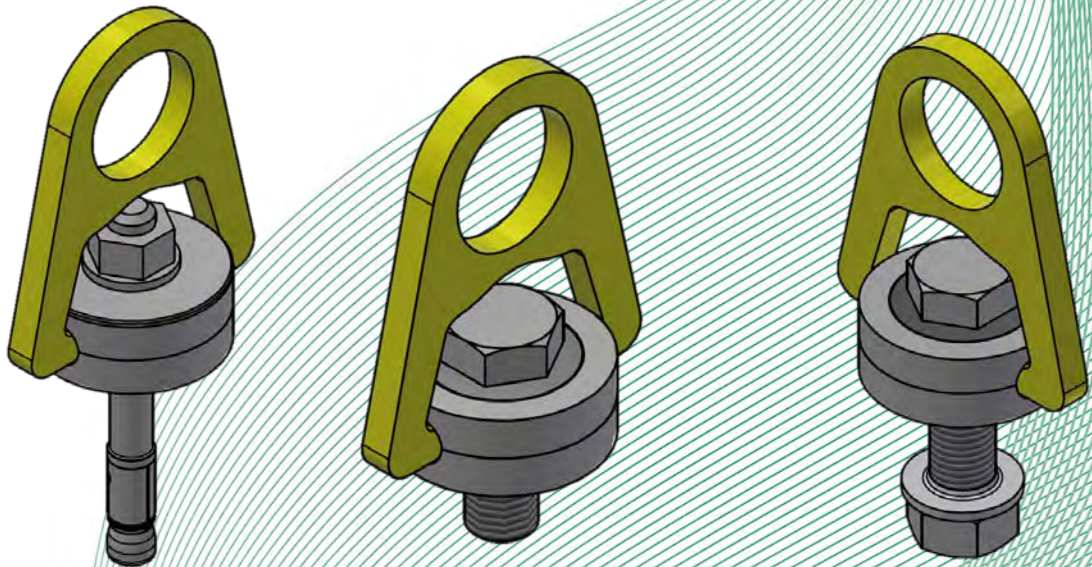

ABS-Lock® -360-B

ABS-Lock®-360-St for screwing
M16 or M20

ABS-Lock® -360-St for countering M16

Fig. 1 – 3: Anchor device type ABS-Lock® -360 and its possible variants

- (15) Report

PB 22-102_Rev.01, 2024-04-26